

Modular Compressed Air Piping Solutions



Dr. Compresso





*"From design to delivery, our purpose is clear.
We aim to empower industries with reliable piping
solutions that never let you down."*

Welcome to **Secure Air**.

With every product we make, we bring together precision engineering, global standards, and an unwavering commitment to quality. As a proud Indian manufacturer, we are shaping the future of compressed air management for industries across the globe.





About SecureAir

More than products, we deliver trust.

Secure Air is a leading manufacturer of aluminum compressed air piping systems. With 40+ years of experience, state-of-the-art factories, and globally certified processes, we ensure durability, efficiency, and peace of mind.



Manufacturing plant equipped with modern facilities



ISO-certified,
BIS standards
compliant



Serving 3,500+
projects across
industries



Vision :

To redefine compressed air systems with superior quality and efficiency.



Mission :

Delivering reliable, innovative, and sustainable piping solutions.



Focus :

100% Made in India. Built to global standards



Why choose SecureAir?



Quality & Durability

Corrosion-resistant, High-strength materials



Leak-Free Assurance

Tested for Zero-Loss Performance



Faster Installation

Easy-to-Fit Modular Systems



Widest Range

From 20mm to 200mm Piping Solutions



Trusted Support

350+ SKUs in Stock, Quick Deliveries

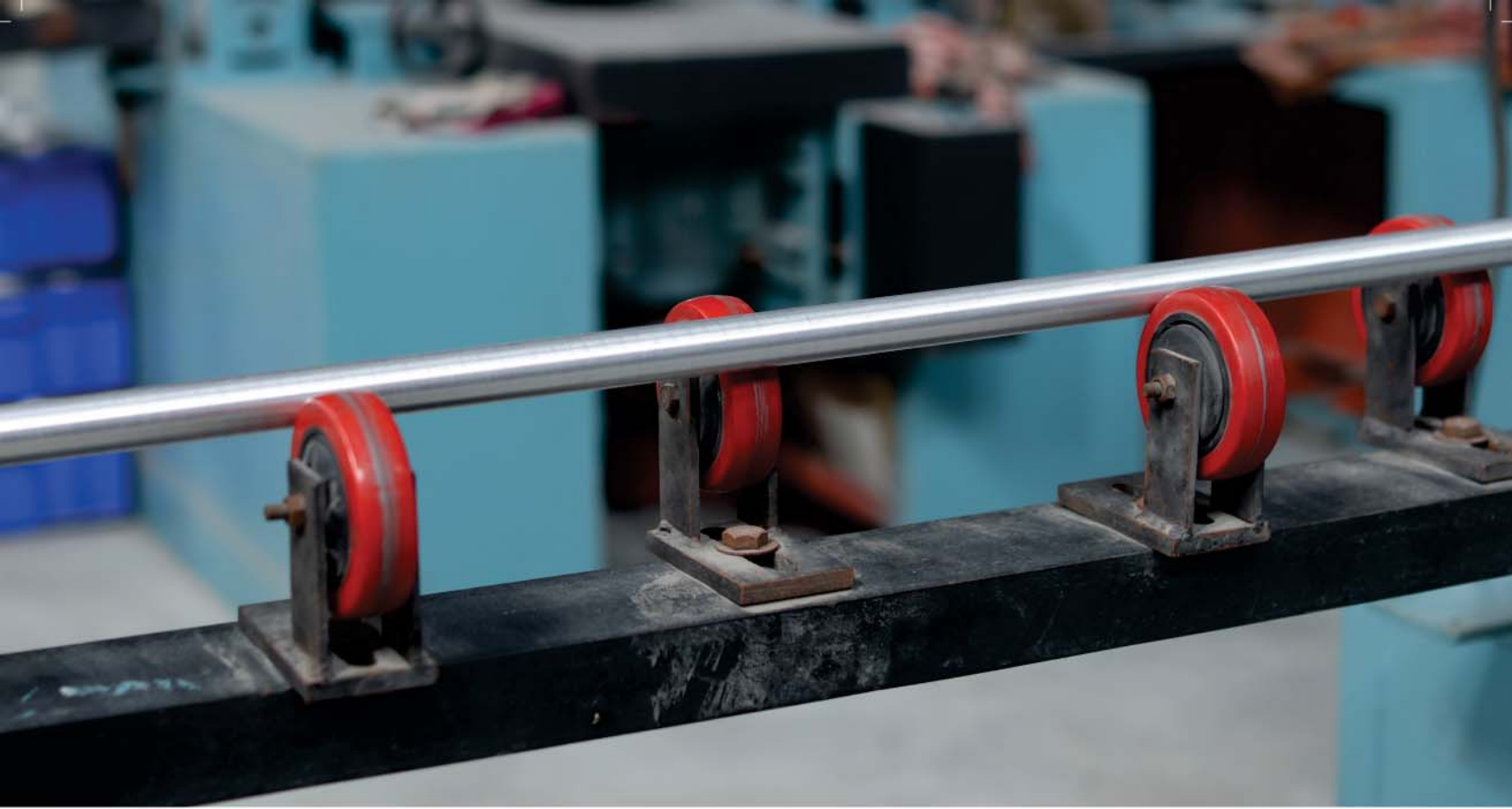

Manufacturing Excellence

"Excellence isn't an act, it's our everyday process."

At **Secure Air**, our ISO-certified plant is equipped with cutting-edge technology that ensures world-class quality. Each product undergoes rigorous testing, ensuring durability and reliability. Our processes are eco-conscious, reducing waste and energy consumption, because a greener tomorrow is part of our commitment.





Industries Served

"Wherever compressed air flows, Secure Air goes."



Automotive
& Ancillaries



Pharmaceuticals



Food &
Beverage



Textiles &
Garments



General
Manufacturing



Warehousing
& Logistics

Engineering Standards

- ASME B31.1 & B31.3
- 2. 6063T5
- UL94HB
- UL94V-2
- PED 2014/68/EU
- TS
- ASTM B241
- EN 755-8
- GB/T4437
- 1-2000
- JIS H4080
- EN 755-9



Dr. Compresso



Advantages/Comparison Secure Air vs Prevailing Market

- Innovative **CASTED TEETH TECHNOLOGY** (Patent Pending)
- Innovative **INTERLOCKING MALE AND FEMALE CONNECTOR SYSTEM** (Patent Pending)
- Innovative **CASTED GROOVE SYSTEM** (No Lugging in Extruded Pipe) (Cut and Use Anywhere)(Recessed Grooves in Fittings, Fits Better) (Patent Pending)
- Innovative **MIN MAX GUIDED MARKING FOR CONNECTIONS** (Patent Pending)
- **100% Guaranteed Leak Proof, Impregnated Castings For ZERO Leakages** (Substantial Savings on Electricity Bills, Lower Maintenance costs for compressors).
- **Ease of Installation, Speed of Installation, Fully Modular.**
- **Bigger ID in the Same Size : More Air Delivery in Same Costs.**

Pipe Size	Pipe ID Secure Air	Pipe ID Competition	Air Delivery Secure Air (CuM)	Air Delivery Competition (CuM)	% Improvement
DN20	20.00	17.10	31.40	22.95	36.79%
DN25	25.00	21.90	49.06	37.65	30.31%
DN40	40.00	36.50	125.60	104.58	20.10%
DN50	50.00	45.70	196.25	163.95	19.70%
DN63	63.00	58.90	311.57	272.33	14.41%

- **Make Any Size from Any Size with Just One connection.**
- **Interchangeability** : Fully Compatible with Any System/Any Make with just One Connection of Male Thread Adapter(Sr No 44) / Female Thread adapter(Sr No 53) for all Expansion / Maintenance of Current or Future Projects.
- Superior technology in **Casting, Extrusion, Machining, Impregnation and Coating.**
- Superior Materials, **SS 304** Hardware.
- **Stoppers in Rubber Seals** to prevent overrun of pipes in fitting.
- **Tested at 30 Bar, Operating Pressure Maximum 16 Bar.**
- **Guaranteed 15 Years.**
- **40+ Years of Manufacturing Excellence.**
- **Made in INDIA - For the World - BIS Certified - Faster Supply Chain**
- **Quick Drops** : Uniform Air Delivery by Eliminating Bottle Necks with **Larger Pipe Holes.**
- **Environmentally Friendly, Recyclable.**

11. Aluminium Pipe (AP) Blue (RAL5012)



Sr. No.	Item Code	Sizes (mm) (ID)	OD (mm)	Length (m)
11.11	AP203	20.00	22.70	2.90
11.12	AP206	20.00	22.70	5.80
11.21	AP253	25.00	27.80	2.90
11.22	AP256	25.00	27.80	5.80
11.31	AP403	40.00	43.50	2.90
11.32	AP406	40.00	43.50	5.80
11.41	AP503	50.00	53.90	2.90
11.42	AP506	50.00	53.90	5.80
11.51	AP633	63.00	67.70	2.90
11.52	AP636	63.00	67.70	5.80
11.61	AP803	80.00	84.90	2.90
11.62	AP806	80.00	84.90	5.80
11.71	AP1003	100.00	105.30	2.90
11.72	AP1006	100.00	105.30	5.80
11.81	AP1503	150.00	155.70	2.90
11.82	AP1506	150.00	155.70	5.80
11.91	AP2003	200.00	206.30	2.90
11.92	AP2006	200.00	206.30	5.80

Green(RAL6032), Yellow(RAL1024), Grey(RAL7046), Red(RAL3001) also available. When Ordering Put Respective Names for Specific Colour.

15. Straight Connector (SC)



15.11

Sr. No.	Item Code	Sizes (mm)	L (mm)	W (mm)	H (mm)
15.11	SC20	20	58	52	41
15.21	SC25	25	62	54	45
15.31	SC40	40	74	72	64
15.41	SC50	50	83	83	77
15.51	SC63	63	95	110	91
15.61	SC80	80	100	155	120
15.71	SC100	100	100	180	142
15.81	SC150	150	110	230	189
15.91	SC200	200	120	280	245

Recommended Tightening Torque :
 20mm, 25mm, 40mm, 50mm : 4 Nm ~ 6 Nm
 63mm, 80mm, 100mm : 10 Nm ~ 14 Nm
 150mm, 200mm : 20 Nm ~ 24 Nm

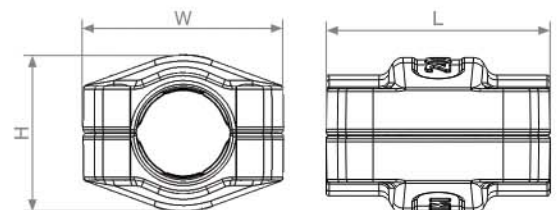

20. Reducer Connector (RC)



20.32

Sr. No.	Item Code	Sizes (mm)	L (mm)	W (mm)	H (mm)
20.21	RC2520	25 x 20	60	54	45
20.31	RC4025	40 x 25	73	72	64
20.32	RC4020	40 x 20	75	72	64
20.41	RC5040	50 x 40	74	83	77
20.42	RC5025	50 x 25	79	83	77
20.43	RC5020	50 x 20	79	83	77

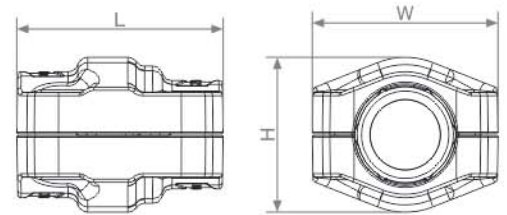

20.83

Sr. No.	Item Code	Sizes (mm)	L (mm)	W (mm)	H (mm)
20.51	RC6350	63 x 50	199	110	91
20.52	RC6340	63 x 40	199	110	91
20.61	RC8063	80 x 63	205	155	120
20.62	RC8050	80 x 50	210	155	120
20.63	RC8040	80 x 40	215	180	120
20.71	RC10080	100 x 80	215	180	142
20.72	RC10063	100 x 63	215	180	142
20.73	RC10050	100 x 50	215	180	142
20.81	RC150100	150 x 100	230	235	196
20.82	RC15080	150 x 80	230	232	196
20.83	RC15063	150 x 63	230	232	196
20.91	RC200150	200 x 150	280	250	245
20.92	RC200100	200 x 100	280	250	245
20.93	RC20080	200 x 80	280	245	245
20.94	RC20063	200 x 63	280	245	245

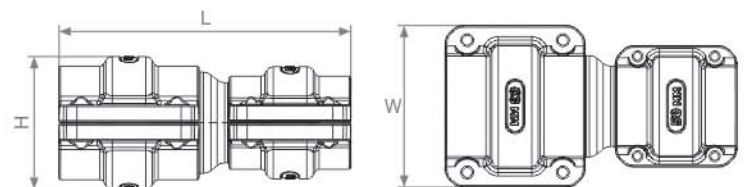

Recommended Tightening Torque :
 20mm, 25mm, 40mm, 50mm : 4 Nm ~ 6 Nm
 63mm, 80mm, 100mm : 10 Nm ~ 14 Nm
 150mm, 200mm : 20 Nm ~ 24 Nm

22. Elbow 90 Degree Body (EL)

22.21

Also Order 2 pieces of Sr No 15 Straight connector(SC) AND/OR Sr No 20 Reducer Connector(RC) Or Combination

Sr. No.	Item Code	Sizes (mm)	L (mm)	W (mm)	H (mm)
22.11	EL20	20	64	64	24
22.21	EL25	25	70	70	29
22.31	EL40	40	93	93	45
22.41	EL50	50	108	108	55
22.51	EL63	63	130	130	70
22.61	EL80	80	160	160	90
22.71	EL100	100	195	195	111
22.81	EL150	150	245	245	159
22.91	EL200	200	285	285	210

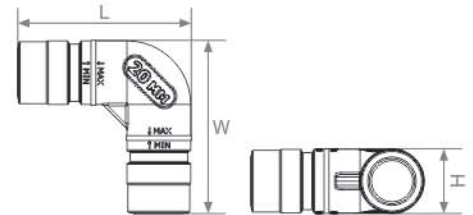

23. Elbow 90 Degree Assembly : Equal (ELA)

23.21

Assembly of Sr No 22 Series Elbow 90 Degree Body (EL) and Sr No 15 Straight Connector (SC)

Sr. No.	Item Code	Sizes (mm)	L (mm)	W (mm)	H (mm)
23.11	ELA20	20	103	103	41
23.21	ELA25	25	110	110	45
23.31	ELA40	40	140	140	64
23.41	ELA50	50	161	161	77
23.51	ELA63	63	189	189	91
23.61	ELA80	80	198	198	120
23.71	ELA100	100	280	280	142
23.81	ELA150	150	335	335	189
23.91	ELA200	200	415	415	245

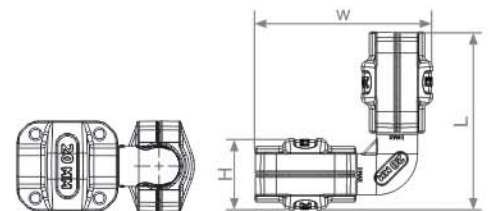

26. Elbow 45 Degree (EH)

26.31

Also Order 2 pieces of Sr No 15 Straight Connector(SC) AND/OR
Sr No 20 Reducer Connector(RC) Or Combination

Sr. No.	Item Code	Sizes (mm)	L (mm)	W (mm)	H (mm)
26.11	EH20	20	72	42	24
26.21	EH25	25	77	45	29
26.31	EH40	40	94	55	45
26.41	EH50	50	103	60	55
26.51	EH63	63	120	70	70
26.61	EH80	80	160	80	90
26.71	EH100	100	185	95	111
26.81	EH150	150	215	110	159
26.91	EH200	200	260	160	210

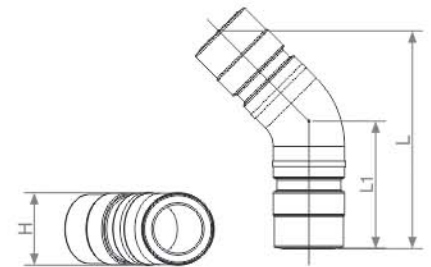

27. Elbow 45 Degree Assembly : Equal (EHA)

27.31

Assembly of Sr No 26 Series Elbow 45 Degree(EH)
and Sr No 15 Straight Connector (SC)

Sr. No.	Item Code	Sizes (mm)	L (mm)	W (mm)	H (mm)
27.11	EHA20	20	123	72	41
27.21	EHA25	25	133	78	45
27.31	EHA40	40	159	93	64
27.41	EHA50	50	175	103	77
27.51	EHA63	63	203	119	91
27.61	EHA80	80	220	133	120
27.71	EHA100	100	250	152	142
27.81	EHA150	150	285	166	189
27.91	EHA200	200	310	180	245

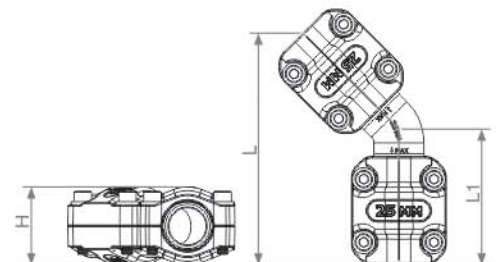

28. Equal T (ET)



28.21

Also Order 3 Pieces of Sr No 15 Straight Connector(SC) AND/OR Sr No 20 Reducer Connector(RC) Or Combination

Sr. No.	Item Code	Sizes (mm)	L (mm)	W (mm)	H (mm)
28.11	ET20	20	104	64	24
28.21	ET25	25	110	70	30
28.31	ET40	40	140	93	45
28.41	ET50	50	160	108	55
28.51	ET63	63	190	130	70
28.61	ET80	80	235	160	90
28.71	ET100	100	280	195	111
28.81	ET150	150	330	245	159
28.91	ET200	200	360	285	210

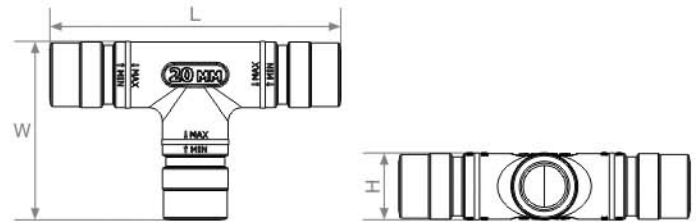

29. Equal T Assembly : Equal (ETA)



29.11

Assembly of Sr No 28 Equal T(ET) and Sr No 15 Straight Connector (SC)

Sr. No.	Item Code	Sizes (mm)	L (mm)	W (mm)	H (mm)
29.11	ETA20	20	164	108	41
29.21	ETA25	25	174	114	45
29.31	ETA40	40	216	144	64
29.41	ETA50	50	245	164	77
29.51	ETA63	63	287	199	91
29.61	ETA80	80	335	240	120
29.71	ETA100	100	385	285	142
29.81	ETA150	150	440	336	189
29.91	ETA200	200	480	440	245

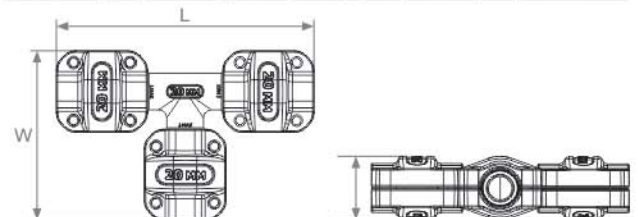

33. Quick Drop Assembly (QDA)

33.21

Assembly of Quick Drop Set and Sr No 15 Straight Connector(SC)
OR Sr No 20 Reducing Connector (RC)

Sr. No.	Item Code	Sizes (mm)	L (mm)	W (mm)	H (mm)	Hole Size (Dia)	Hole Saw Bit Sr. No.
33.21	QDA2520	25 x 20	85	110	45	16mm	85.11
33.22	QDA2525	25 x 25	85	112	44		
33.31	QDA4020	40 x 20	117	143	64	25mm	85.12
33.32	QDA4025	40 x 25	117	140	64		
33.33	QDA4040	40 x 40	117	142	64		
33.41	QDA5020	50 x 20	137	158	77	38mm	85.13
33.42	QDA5025	50 x 25	137	158	77		
33.43	QDA5040	50 x 40	137	153	77		
33.44	QDA5050	50 x 50	137	161	76		
33.51	QDA6320	63 x 20	155	168	83	51mm	85.14
33.52	QDA6325	63 x 25	155	168	83		
33.53	QDA6340	63 x 40	155	163	83		
33.54	QDA6350	63 x 50	155	171	83		
33.61	QDA8020	80 x 20	155	171	83		
33.62	QDA8025	80 x 25	175	168	83		
33.63	QDA8040	80 x 40	175	168	83		
33.64	QDA8050	80 x 50	175	170	83		
33.71	QDA10020	100 x 20	200	175	83		
33.72	QDA10025	100 x 25	200	175	83		
33.73	QDA10040	100 x 40	200	180	83		
33.74	QDA10050	100 x 50	200	190	83		
33.81	QDA15020	150 x 20	240	190	83		
33.82	QDA15025	150 x 25	240	190	83		
33.83	QDA15040	150 x 40	240	195	83		
33.84	QDA15050	150 x 50	240	200	83		
33.91	QDA20020	200 x 20	295	205	83		
33.92	QDA20025	200 x 25	295	205	83		
33.93	QDA20040	200 x 40	295	210	83		
33.94	QDA20050	200 x 50	295	220	83		

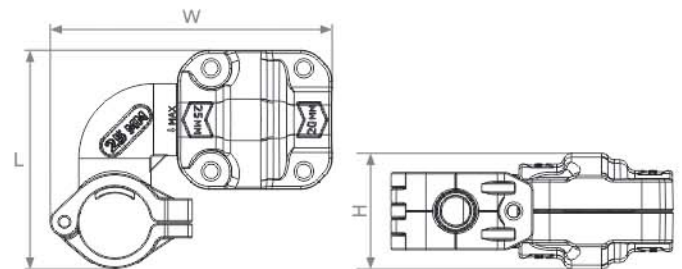

40. End Cap (EC)



Also Order 1 pieces of Sr No 15 Straight connector(SC)

Sr. No.	Item Code	Sizes (mm)	L (mm)	W (mm)
40.11	EC20	20	40	24
40.21	EC25	25	46	29
40.31	EC40	40	50	45
40.41	EC50	50	55	55
40.51	EC63	63	63	70
40.61	EC80	80	65	90
40.71	EC100	100	70	111
40.81	EC150	150	82	159
40.91	EC200	200	85	210

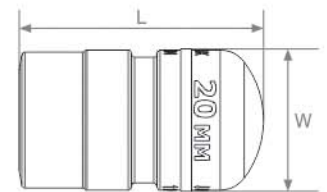

42. Female Threaded Valve (FV)



Assembly of Sr No 28 Equal T(ET) and Sr No 15 Straight Connector (SC)

Sr. No.	Item Code	Sizes (inches)	Type
42.01	FV12	1/2 x 1/2 BSP	Ball
42.11	FV20	3/4 x 3/4 BSP	Ball
42.21	FV25	1 x 1 BSP	Ball
42.25	FV32	1 1/4 x 1 1/4 BSP	Ball
42.31	FV40	1 1/2 x 1 1/2 BSP	Ball
42.41	FV50	2 x 2 BSP	Ball
42.51	FV63	2 1/2 x 2 1/2 BSP	Ball
42.61	FV80	3 x 3 BSP	Ball
42.71	FV100	4 x 4 BSP	Ball



Sr. No.	Item Code	Sizes (inches)	Type
42.81	FV150	6	Butterfly
42.91	FV200	8	Butterfly

44. Male Threaded Adaptor (MT)



44.22

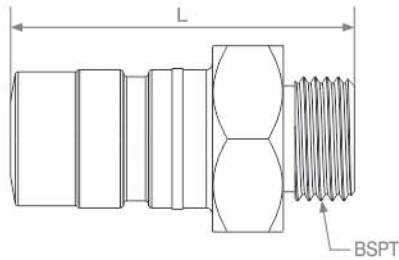

Sr. No.	Item Code	Sizes	L (mm)	Thread Size (BSP)
44.11	MT20-1/2	20mm x 1/2" BSP	59	1/2"
44.12	MT20-3/4	20mm x 3/4" BSP	59	3/4"
44.21	MT25-1/2	25mm x 1/2" BSP	63	1/2"
44.22	MT25-3/4	25mm x 3/4" BSP	65	3/4"
44.23	MT25-1	25mm x 1" BSP	66	1"
44.31	MT40-1	40mm x 1" BSP	72	1"
44.32	MT40-1.1/4	40mm x 1 1/4" BSP	73	1 1/4"
44.33	MT40-1.1/2	40mm x 1 1/2" BSP	72	1 1/2"
44.34	MT40-2	40mm x 2" BSP	72	2"
44.44	MT50-2	50mm x 2" BSP	78	2"
44.51	MT63-2	63mm x 2" BSP	89	2"
44.52	MT63-2.1/2	63mm x 2 1/2" BSP	90	2 1/2"
44.61	MT80-2.1/2	80mm x 2 1/2" BSP	94	2 1/2"
44.62	MT80-3	80mm x 3" BSP	96	3"
44.71	MT100-3	100mm x 3" BSP	102	3"
44.72	MT100-4	100mm x 4" BSP	105	4"

Also Order 1 Piece of Sr No 15 Straight Connector(SC)
OR Sr No 20 Reducer Connector(RC)

45. Male Threaded Adaptor Assembly (MTA)



45.11

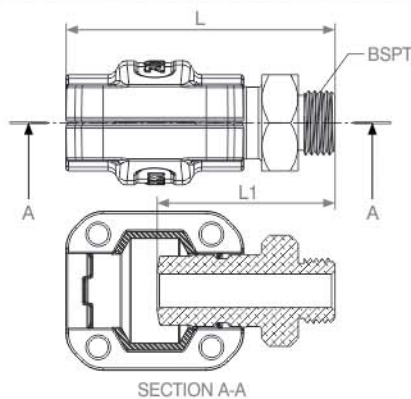

Sr. No.	Item Code	Sizes	L (mm)	L1 (mm)	Thread Size (BSP)
45.11	MTA20-1/2	20mm x 1/2" BSP	88	59	1/2"
45.12	MTA20-3/4	20mm x 3/4" BSP	89	59	3/4"
45.21	MTA25-1/2	25mm x 1/2" BSP	94	63	1/2"
45.22	MTA25-3/4	25mm x 3/4" BSP	97	65	3/4"
45.23	MTA25-1	25mm x 1" BSP	98	66	1"
45.31	MTA40-1/2	40mm x 1" BSP	109	72	1"
45.32	MTA40-1	40mm x 1 1/4" BSP	110	73	1 1/4"
45.33	MTA40-1.1/4	40mm x 1 1/2" BSP	109	72	1 1/2"
45.34	MTA40-1.1/2	40mm x 2" BSP	109	72	2"
45.44	MTA50-2	50mm x 2" BSP	120	78	2"
45.51	MTA63-2	63mm x 2" BSP	136	89	2"
45.52	MTA63-2.1/2	63mm x 2 1/2" BSP	138	90	2 1/2"
45.61	MTA80-2.1/2	80mm x 2 1/2" BSP	144	94	2 1/2"
45.62	MTA80-3	80mm x 3" BSP	146	96	3"
45.71	MTA100-3	100mm x 3" BSP	152	102	3"
45.72	MTA100-4	100mm x 4" BSP	155	105	3"

Assembly of Sr No 44 Male Thread Adaptor(MT) and
Sr No 15 Straight Connector (SC) OR Sr No 20 Reducer Connector (RC)

46. Female Threaded Valve Assembly : Equal (FVA)



Sr. No.	Item Code	Sizes
46.11	FVA20-1/2	20mm x 1/2" BSP
46.21	FVA25-1/2	25mm x 1/2" BSP
46.22	FVA25-1	25mm x 1" BSP
46.31	FVA40-1/2	40mm x 1/2" BSP
46.32	FVA40-1.1/2	40mm x 1 1/2" BSP
46.41	FVA50-1/2	50mm x 1/2" BSP
46.42	FVA50-2	50mm x 2" BSP
46.51	FVA63-2.1/2	63mm x 2 1/2" BSP
46.61	FVA80-3	80mm x 3" BSP
46.71	FVA100-4	100mm x 4" BSP

Assembly of Sr No 42 Female Thread Valve (FV)
and Sr No 45 Male Thread Adaptor Assembly (MTA)

48. Hex Nipple (HN)



Sr. No.	Item Code	Sizes	L (mm)	Thread Size (BSP)
48.01	HN1/2	1/2" x 1/2" BSP	36	1/2" x 1/2"
48.11	HN3/4	3/4" x 3/4" BSP	38	3/4" x 3/4"
48.21	HN1	1" x 1" BSP	46	1" x 1"
48.25	HN1.1/4	1 1/4" x 1 1/4" BSP	46	1 1/4" x 1 1/4"
48.31	HN1.1/2	1 1/2" x 1 1/2" BSP	46	1 1/2" x 1 1/2"
48.41	HN2	2" x 2" BSP	46	2" x 2"
48.51	HN2.1/2	2 1/2" x 2 1/2" BSP	58	2 1/2" x 2 1/2"
48.61	HN3	3" x 3" BSP	65	3" x 3"

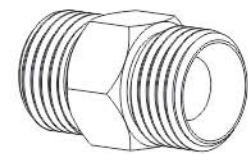
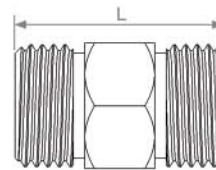

49. Male - Female Threaded Valve (MF)



Sr. No.	Item Code	Sizes
49.01	MF1/2	1/2" x 1/2" BSP
49.11	MF3/4	3/4" x 3/4" BSP
49.21	MF1	1" x 1" BSP
49.25	MF1.1/4	1 1/4" x 1 1/4" BSP
49.31	MF1.1/2	1 1/2" x 1 1/2" BSP
49.41	MF2	2" x 2" BSP
49.51	MF2.1/2	2 1/2" x 2 1/2" BSP
49.61	MF3	3" x 3" BSP

Assembly of Sr 48 Hex Nipple(HN) and Sr No 42 Female Thread Valve (FV)

50. Male-Female Valve Assembly (MFA)



50.12

Sr. No.	Item Code	Sizes
50.11	MFA20-1/2	20mm x 1/2" BSP
50.12	MFA20-3/4	20mm x 3/4" BSP
50.21	MFA25-1	25mm x 1" BSP
50.31	MFA40-1.1/2	40mm x 1 1/2" BSP
50.41	MFA50-2	50mm x 2" BSP
50.51	MFA63-2.1/2	63mm x 2 1/2" BSP
50.61	MFA80-3	80mm x 3" BSP

Assembly of Sr No 49 Male - Female Threaded Vale and Sr No 44 Male Threaded Adaptor (MT)
Also Order 1 Piece of Sr No 15 Straight Connector(SC) OR Sr No 20 Reducer Connector(RC)

51. Male-Female Valve Assembly with Valve (MFV)



51.12

Sr. No.	Item Code	Sizes
51.11	MFV20-1/2	20mm x 1/2" BSP
51.12	MFV20-3/4	20mm x 3/4" BSP
51.21	MFV25-1	25mm x 1" BSP
51.31	MFV40-1.1/2	40mm x 1 1/2" BSP
51.41	MFV50-2	50mm x 2" BSP
51.51	MFV63-2.1/2	63mm x 2 1/2" BSP
51.61	MFV80-3	80mm x 3" BSP

Assembly of Sr No 50 Male Female Valve Assembly (MFA) and Sr No 15 Straight Connector (SC)

53. Female Threaded Adaptor (FT)



53.11

Sr. No.	Item Code	Sizes	L (mm)	Thread Size (BSP)
53.11	FT20-1/2	20mm x 1/2" BSP	58	1/2"
53.12	FT20-3/4	20mm x 3/4" BSP	61	3/4"
53.21	FT25-1/2	25mm x 1/2" BSP	64	1/2"
53.22	FT25-1	25mm x 1" BSP	71	1"
53.31	FT40-1.1/2	40mm x 1 1/2" BSP	75	1 1/2"
53.41	FT50-2	50mm x 2" BSP	86	2"
53.51	FT63-2.1/2	63mm x 2 1/2" BSP	90	2 1/2"
53.61	FT80-3	80mm x 3" BSP	95	3"

Also Order 1 pieces of Sr No 15 Straight connector(SC)
OR Sr No 20 Reducer Connector(RC)

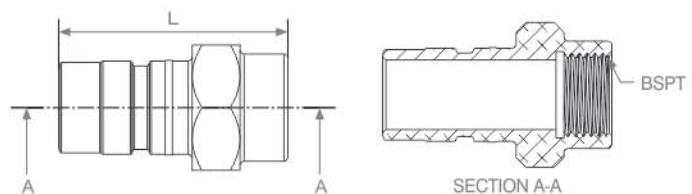

54. Female Threaded Adaptor Assembly : Equal (FTA)



54.11

Sr. No.	Item Code	Sizes	L (mm)	L1 (mm)	Thread Size (BSP)
54.11	FTA20-1/2	20mm x 1/2" BSP	88	58	1/2"
54.12	FTA20-3/4	20mm x 3/4" BSP	91	61	3/4"
54.21	FTA25-1/2	25mm x 1/2" BSP	96	64	1/2"
54.22	FTA25-1	25mm x 1" BSP	103	71	1"
54.31	FTA40-1.1/2	40mm x 1 1/2" BSP	112	75	1 1/2"
54.41	FTA50-2	50mm x 2" BSP	128	87	2"
54.51	FTA63-2.1/2	63mm x 2 1/2" BSP	139	91	2 1/4"
54.61	FTA80-3	80mm x 3" BSP	148	98	3"

Assembly of Sr 53 Female Thread Adaptor (FT) and Sr No 15 Straight connector(SC) OR Sr No 20 Reducer Connector(RC)

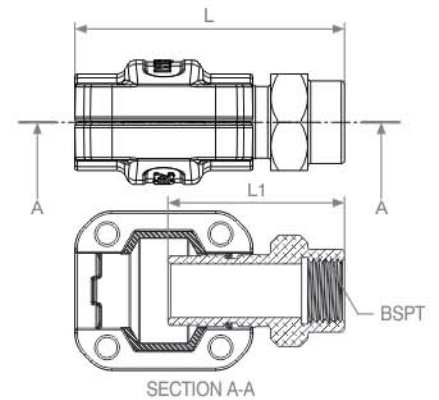

56. Plug Valve (PV)



56.21

Sr. No.	Item Code	Sizes (mm)	Type
56.11	PV20	20	Ball
56.21	PV25	25	Ball
56.31	PV40	40	Ball
56.41	PV50	50	Ball
56.51	PV63	63	Ball
56.61	PV80	80	Ball
56.71	PV100	100	Ball



56.81

Sr. No.	Item Code	Sizes (mm)	Type
56.81	PV150	150	Butterfly
56.91	PV200	200	Butterfly

Assembly of Sr No 42 Female Threaded Valve(FV) and Sr no 44 Male Threaded Adaptor(MT)
Also Order 2 pieces of Sr No 15. Straight Connector and / Or Sr 20 Reducer Connector (RC) or Combination

57. Plug Valve Assembly : Equal (PVA)



Sr. No.	Item Code	Sizes (mm)	Type
57.11	PVA20	20	Ball
57.21	PVA25	25	Ball
57.31	PVA40	40	Ball
57.41	PVA50	50	Ball
57.51	PVA63	63	Ball
57.61	PVA80	80	Ball
57.71	PVA100	100	Ball



Sr. No.	Item Code	Sizes (mm)	Type
57.81	PVA150	150	Butterfly
57.91	PVA200	200	Butterfly

Assembly of Sr No 56 Plug Valve (PV) and Sr no 15 Straight Connector (SC)

59. Flange Connector (FC)



Sr. No.	Item Code	Sizes	D1	D2	D3	H	BOLT SIZE
59.51	FC63	63	185	145	18	85	M16
59.61	FC80	80	200	160	18	85	M16
59.71	FC100	100	220	180	18	92	M16
59.81	FC150	150	285	240	22	100	M20
59.91	FC200	200	340	295	22	110	M20

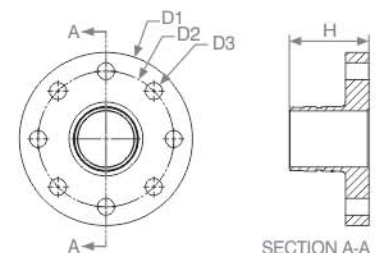

Also Order 1 pieces of Sr No 15 Straight Connector(SC)
and / Or Sr 20 Reducer Connector (RC)

60. Flange Connector with Straight Connector : Equal (FCA)

60.51

Also Order 1 pieces of Sr No 15 Straight Connector(SC)
and/or Sr 20 Reducer Connector (RC)

Sr. No.	Item Code	Sizes	D	H	BOLT SIZE
60.51	FCA63	63	185	133	M16
60.61	FCA80	80	200	135	M16
60.71	FCA100	100	220	142	M16
60.81	FCA150	150	285	155	M20
60.91	FCA200	200	340	165	M20

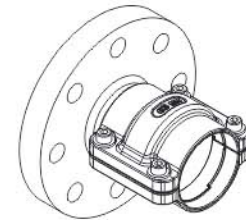
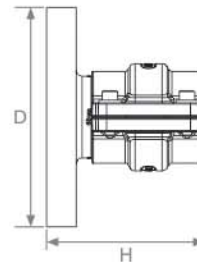

70. V Seal (VS)

70.21
70.22

Sr. No.	Item Code	Sizes (mm)
70.11	VS20	20
70.21	VS25	25
70.22	VS25-20	25 x 20
70.31	VS40	40
70.32	VS40-25	40 x 25
70.33	VS40-20	40 x 20
70.41	VS50	50
70.42	VS50-40	50 x 40
70.43	VS50-25	50 x 25
70.44	VS50-20	50 x 20
70.51	VS63	63
70.52	VS63-50	63 x 50
70.53	VS63-40	63 x 40
70.61	VS80	80
70.71	VS100	100
70.81	VS150	150
70.91	VS200	200

74. Pipe Clip (PC)

74.41

Sr. No.	Item Code	Sizes (mm)
74.11	PC20	20
74.21	PC25	25
74.31	PC40	40
74.41	PC50	50
74.51	PC63	63
74.61	PC80	80
74.71	PC100	100

72. Drop Seal (DS)

72.21

Sr. No.	Item Code	Sizes (mm)
72.21	DS25	25
72.31	DS40	40
72.41	DS50	50
72.51	DS63	63
72.61	DS80	80
72.71	DS100	100
72.81	DS150	150
72.91	DS200	200

74.81

74.81	PC150	150
74.91	PC200	200

75. Flexible Hose Assembly (FHA)



Sr. No.	Item Code	Sizes
75.11	FHA20-1	20mm x 1 Mtr
75.12	FHA20-2	20mm x 2 Mtr
75.21	FHA25-1	25mm x 1 Mtr
75.22	FHA25-2	25mm x 2 Mtr
75.31	FHA40-1	40mm x 1 Mtr
75.32	FHA40-2	40mm x 2 Mtr
75.41	FHA50-1	50mm x 1 Mtr
75.42	FHA50-2	50mm x 2 Mtr
75.51	FHA63-1	63mm x 1 Mtr
75.52	FHA63-2	63mm x 2 Mtr
75.61	FHA80-1	80mm x 1 Mtr
75.62	FHA80-2	80mm x 2 Mtr
75.71	FHA100-1	100mm x 1 Mtr
75.72	FHA100-2	100mm x 2 Mtr

Assembly of 75.Flexible Hose(FHA) and Sr 15. Straight Connector (SC)

76. To 79. Hardware

SS 304 Bolts Assembly



Sr. No.	Item Code	Sizes
76.11	HW50	For Straight Connector & Reducing Connector Dia 20,25,40,50 - M6 x 30
76.12	HW51	FOR Quick Drop 25,40,50 - M6 x 20
76.51	HW100	For Straight Connector & Reducing Connector & Quick Drop Dia : 63,80,100 - M8 x 32
76.81	HW200	For Straight Connector & Reducing Connector & Quick Drop Dia: 150,200 - M10 x 35

T Bolts



Sr. No.	Item Code	Sizes
76.91	TBMB-50	T Bolt M8 x 50
76.92	TBMB-60	T Bolt M8 x 60
76.93	TBMB-70	T Bolt M8 x 70

Iron Expansion Bolt



Sr. No.	Item Code	Sizes
76.96	IEM8	Iron Expansion M8
76.97	IEM10	Iron Expansion M10

Wall Support Bracket



Sr. No.	Item Code	Sizes
78.11	WB300	Wall Bracket 300mm
78.21	WB500	Wall Bracket 500mm
78.31	WB1200	Wall Bracket 1200mm

Knot Tie

 79.11	Sr. No.	Item Code	Sizes
	79.11	KTM8	Knot Tie M8

80. To 90. Accessories

	Sr. No.	Item Code	Description
 80.11	80.11	DE11	Pipe Deburring
 80.12	80.12	DE12	Hole Deburring
 82.11	82.11	CU63	Pipe Cutter DN6 - 63 mm
	82.12	CU110	Pipe Cutter DN40 -110 mm
 85.11	85.11	HS16	Hole Saw Bit D16 - 25mm Pipe
	85.12	HS25	Hole Saw Bit D25 - 40mm Pipe
	85.13	HS38	Hole Saw Bit D38 - 50mm Pipe
	85.14	HS51	Hole Saw Bit D51 - 63, 80, 100, 150, 200mm
 87.11	87.11	TW11	Torque Wrench Manual
 88.11	88.11	TT11	Teflon Tape (12mm x 0.1mm x 10Mtr)
 90.11	90.11	MSB	Master Sample Box

Secure Air Diameter Selection

Selection Chart											
Flow	Flow										
cub feet/min	N m3/h	50M	100M	150M	300M	500M	750M	1000M	1300M	1600M	2000M
8	13	20	20	20	20	20	20	20	20	20	20
24	40	20	20	20	20	20	20	20	25	25	25
40	65	20	20	20	20	25	25	25	25	25	40
51	91	20	20	20	25	25	25	40	40	40	40
76	130	20	20	25	25	40	40	40	40	40	40
115	195	20	25	25	40	40	40	40	40	40	40
176	300	25	40	40	40	40	40	50	50	50	50
250	420	40	40	40	40	50	50	50	50	63	63
350	600	40	40	40	50	50	50	63	63	63	63
530	900	40	40	50	50	63	63	63	63	63	80
700	1200	40	50	50	63	63	63	63	80	80	80
890	1500	50	50	63	63	63	80	80	80	80	80
1050	1800	50	50	63	63	63	80	80	80	80	100
1236	2150	50	63	63	63	80	80	80	100	100	100
1412	2400	50	63	63	80	80	80	100	100	100	100
1500	2600	63	63	63	80	80	100	100	100	100	150
1766	3000	63	63	80	80	100	100	100	150	150	150
2060	3500	63	63	80	80	100	100	150	150	150	150
2354	4000	63	80	80	100	100	150	150	150	150	150
2649	4500	63	80	80	100	100	150	150	150	150	150
2942	5000	63	80	80	100	150	150	150	150	150	150
3237	5500	80	80	80	100	150	150	150	150	150	150
3531	6000	80	80	100	100	150	150	150	150	150	150
3826	6500	80	80	100	150	150	150	150	150	150	150
4238	7200	80	100	100	150	150	150	150	150	150	200
4709	8000	80	100	100	150	150	150	150	150	150	200
5002	8500	80	100	100	150	150	150	150	150	200	200
5886	10000	80	100	150	150	150	150	150	200	200	200
7063	12000	100	150	150	150	150	150	200	200	200	200

Closed loop system at 8bar with 5% allowable pressure drop.



Futuristic Solutions for Compressed Air



Dr. Compresso



MADE IN INDIA



Dr. Compresso



Middle east Distributor:



Aamtron Group
General Contracting W.L.L

info@aamtrongroup.com
<https://www.aamtrongroup.com/>
<https://www.airlinepiping.com/>
+974 66658078, +974 44726271